

PROCESS PRESSURE TRANSMITTER

PTX24 SERIES

- GAUGE or ABSOLUTE
- 2 WIRE (4 to 20) mA OUTPUT
- DIGITAL DISPLAY OPTION
- HYGIENIC FITTINGS
- IP65 SEALED
- FLANGED FITTINGS



INTRODUCTION

The PTX24 is an accurate 2 wire pressure transmitter providing a (4 to 20) mA output over a wide pressure range. The piezoresistive element provides excellent accuracy and stability in an all welded stainless steel housing. Span and Zero potentiometers are provided for fine adjustment or periodic re-calibration. The PTX24 is available in a wide range of process connections and can have an optional local display.

SPECIFICATION @ 20 °C

INPUT		OUTPUT	(4 to 20) mA, two wire
Type	Gauge or absolute	Accuracy	
		Standard	± 0.5 % FS (0 to 600) bar
		Optional	± 0.25 % FS (0 to 600) bar ± 0.1 % FS (0.1 to 600) bar
Pressure Range	Standard DIN pressure ranges	Operating Temp. Range (electronics)	
Styles 1, 2 and 7	from (0 to 100) mbar to (0 to 600) bar full scale	Standard	(0 to 70) °C
Styles 3 and 4	from (0 to 100) mbar to (0 to 30) bar full scale	Option	(-25 to 85) °C
Over Pressure	The rated pressures can be exceeded to the following limits without degrading performance: 3 bar for ranges up to 2 bar 3 x FS for ranges (2 to 600) bar	Electrical Connection	
Burst Pressure		PTX24	
Gauge	200 bar for ranges (0 to 25) bar 850 bar for ranges (25 to 600) bar	SCH4	
Option	1500 bar for ranges > 25 bar	M20 Cable entry	
Supply Voltage	(9 to 33) vdc	NOTE: Combined Non-linearity, Hysteresis and Repeatability will not deviate from the straight line connecting Zero and FS output by more than the accuracy stated.	
Load Resistor	$\frac{(V_{\text{supply}} - 9)}{20} \times 10^3 \Omega$ maximum	APPROVALS	
Process Compatibility	Fluids compatible with a fully welded assembly of stainless steel with viton seals, other materials to order.	EMC	
		Emissions	EN 61000-6-3
		Susceptability	EN 61000-6-2
		Optional	EN 61000-4-5 Surge (lightning strikes)

PROCESS PRESSURE TRANSMITTER

MECHANICAL DETAILS

STYLE 1 - 1/4" BSPF

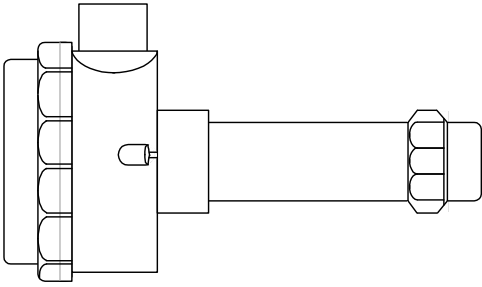

STYLE 2 - 1/2" BSPM FLUSH DIAPHRAGM

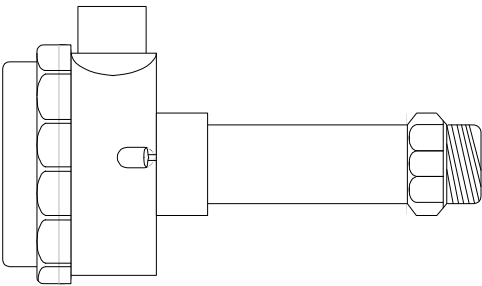

STYLE 3 - HYGIENIC TYPICAL PROFILES*

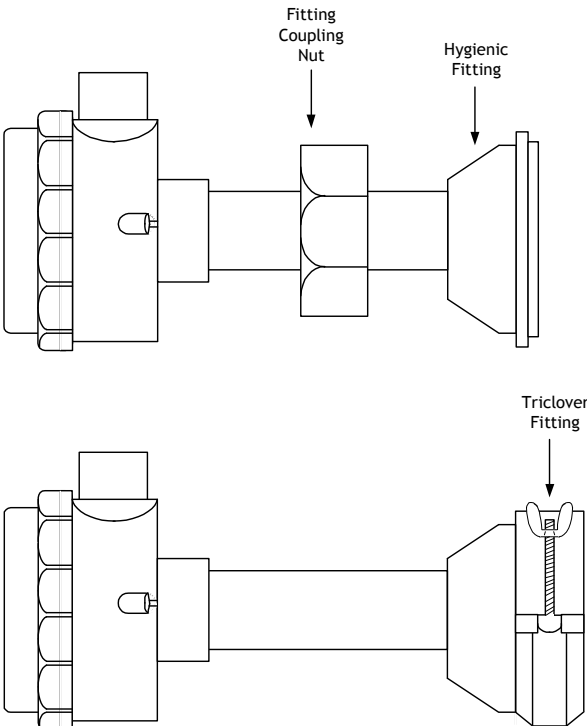

STYLE 4 - FLANGED TYPICAL PROFILE*

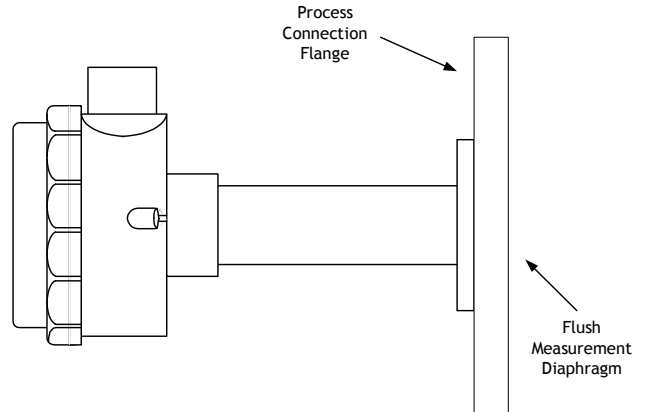

* Profiles will vary depending upon the type of Hygienic fitting and pressure range.

- Gauge Pressure is zero referenced against ambient air pressure
- Absolute Pressure is zero referenced against a perfect vacuum

ORDER CODE :

PTX24 / [] / [] / [] / []

Gauge G
Absolute A

1/4" BSP FEMALE Pressure Fitting	1
1/2" BSP MALE Flush Diaphragm	2
Hygienic - State Type	3
Flanged - State size	4
1/4" BSP MALE Pressure Fitting	5
1/2" BSP MALE Frontal Diaphragm	6

Pressure Range (e.g. (0 to 2) Bar)
Low/High

OPTIONS

Standard Temperature Range (0 to 70) °C	0
Extended Temperature Range (-25 to 85) °C	1
High Accuracy Burst Pressure	2
High Accuracy 0.25 %	3
Compound Reg./PLUS or offset zero	5
0.1 % Accuracy	6
Range below 100 mbar	7
Cooling extension to 150 °C process	8

Example: PTX24/G/1/0/2/1

PTX24 / Gauge / 1/4" BSP FEMALE Pressure Fitting / (0 to 2) Bar
/ Standard Temperature Range (0 to 70) °C

For display option order DM700 cap separately